

SK-D100IR DOME CAMERA

3B05530B



► INSTALLATION

- 1. Opening the dome :** Pushing the latch button, (Remove the protection sheet after installing.)

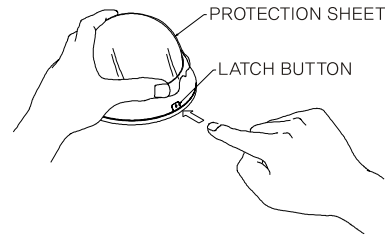

- 2. Removing the dome :** Lift the dome. When you push the latch button, it is unlocked and you can lift the dome.

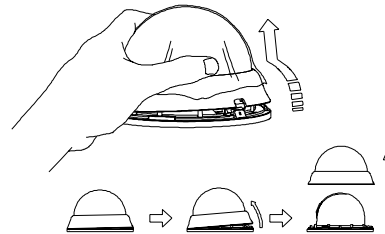

3. Vari-focal lens adjustment

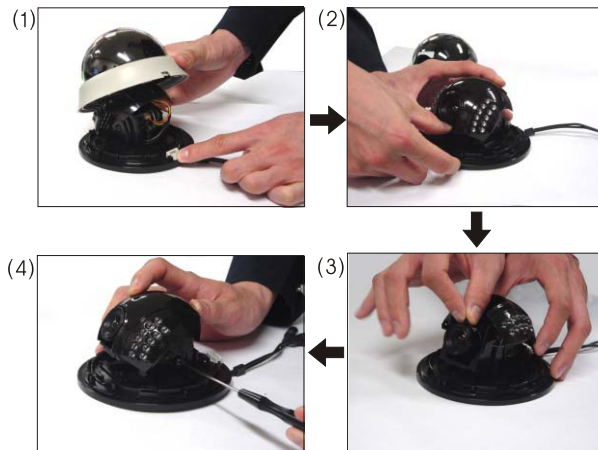

- (1) Push the latch button to open the dome.
- (2) Holding the bottom, lift the inner cover with LEDs.
- (3) Adjust the lens.
- (4) Replace the inner cover and tighten the screw after positioning the camera angle.

- (1) Fix the camera set with the supplied screws on ceiling.
- (2) Re-assemble the camera.
- (3) After installing, you can adjust the direction up to about 40 degree, left or right.

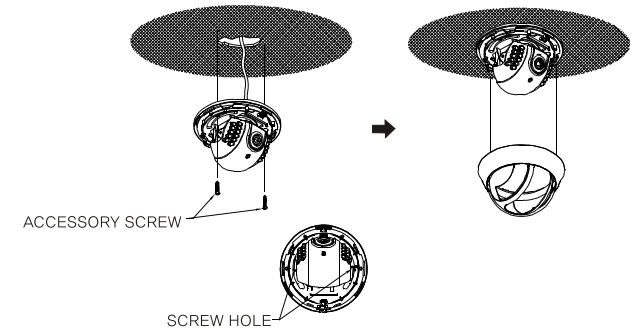

5. Installation finished

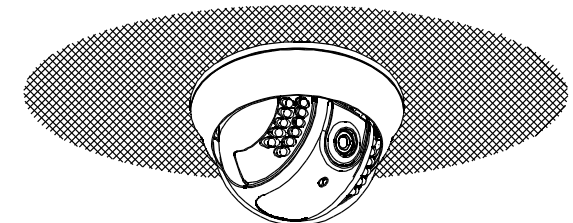

► PRECAUTION

1. Do not install the camera outdoors.
2. Choose an ideal location for the camera, since a camera unit must be protected against moisture and vibration.
3. Be careful not to scratch the camera unit, especially lens glass.
4. Use the camera within the temperature (-10°C~+50°C).
5. Handle with care. Dropping it can cause serious damage to the camera.
6. Avoid any direct sun light toward the lens.
7. Use the AC adaptor 12V DC regulated.

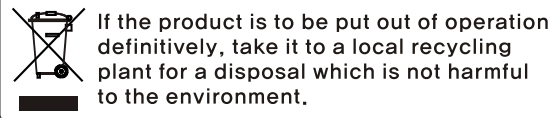

► LENS ADJUSTMENT (Vari-focal Lens only)

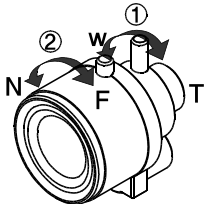

- ① By turning the "Tele-Wide" knob, you can access a range of focal lengths within specified limits.
- ② Since then, by turning the "Near-Far" knob, you can set the focus toward the wanted object.

► DIMENSION

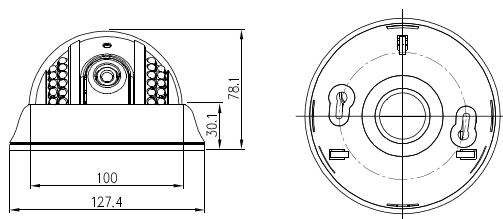

▶ ASSEMBLY

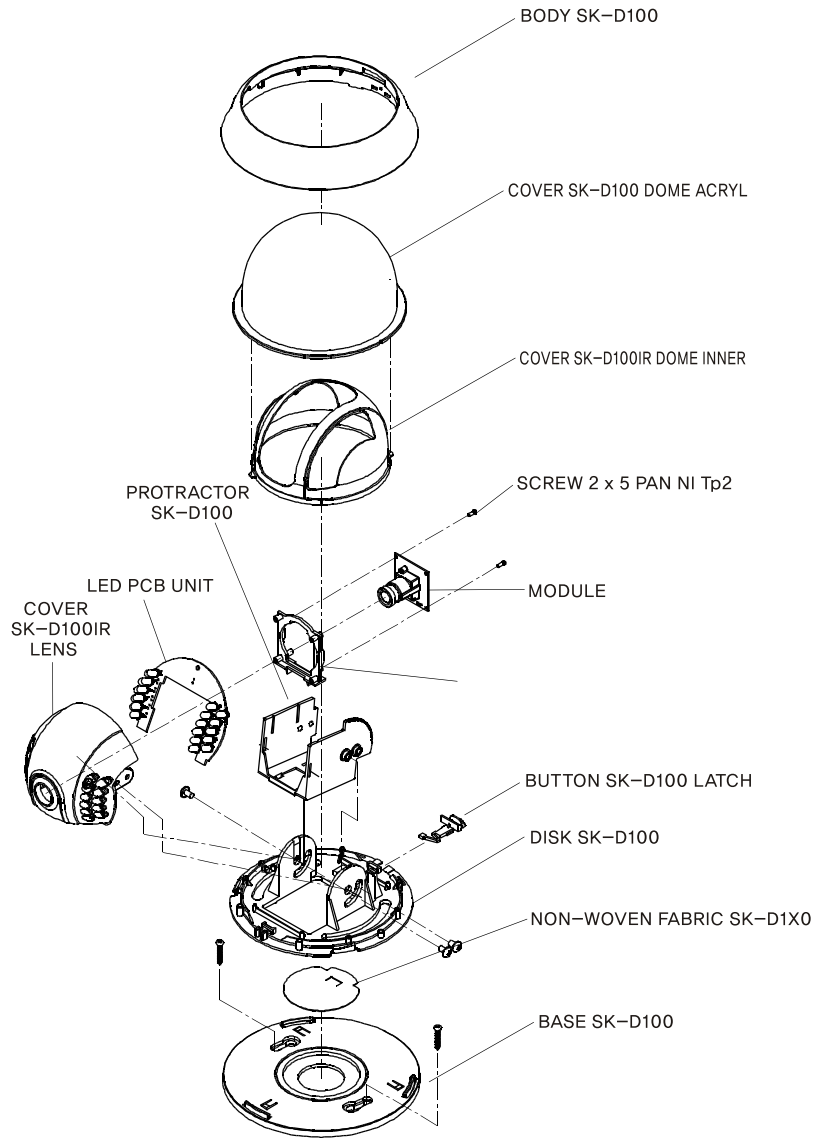

▶ SPECIFICATION

•STANDARD RESOLUTION COLOR CAMERA •DIGITAL ZOOM DAY & NIGHT CAMERA

Model No	SK-D100IR/M504	SK-D100IR/M503(AI)
Image Sensor	1/3" SONY COLOR Super HAD CCD	
Effective pixel	510(H) X 492(V) PIXEL (NTSC) 500(H) X 582(V) PIXEL (PAL)	
Cell Size	9.6 μ m(H) X 7.5 μ m(V) (NTSC) 9.8 μ m(H) X 6.3 μ m(V) (PAL)	
Resolution	380 TV-LINE	
TV Type	NTSC / PAL	
Sync. Type	Internal	
Scanning System	2:1 Interlace	
Video Output	1.0 Vp-p (Sync. Negative)	
Gamma Characteristic	$\gamma = 0.45$ typ.	
Min. Illumination	0 Lux(20M Range) : LED ON 0.1Lux(F/1.2) : LED OFF	
S/N Ratio	45dB or More (AGC OFF)	
Gain Control	Automatic	
Shutter	1/60 ~ 1/100,000 sec(NTSC), 1/50 ~ 1/100,000sec(PAL)	
Test Illuminance Area	Average test illuminance by front view	
Audio gain (option)	40dB \pm 10%	
Max output (option)	600ohm Max 3Vpp \pm 10%	
Freq. Response (option)	300Hz~20KHz	
Audio S/N ratio (option)	-45dB \pm 10%	
Power Supply	Regulated DC 12.0 V	
Consumption Current	Max.370mA (at DC 12V)Without AUDIO, LED ON Max.380mA (at DC 12V) With AUDIO, LED ON	
Reverse Polarity Protection	Yes	
Lens	Board lens or Vari-focal auto Iris lens	
Operation Temp	-10 ~ 50° C	
Preservation Temp	-20 ~ 60° C	

Model No	SK-D100IR/M400X	SK-D100IR/M400XAI
Image Sensor	1/3" SONY COLOR EXview HAD CCD	
Effective pixel	768(H) X 494(V) PIXEL (NTSC) 752(H) X 582(V) PIXEL (PAL)	
Cell Size	6.35 μ m(H) X 7.4 μ m(V) (NTSC) 6.5 μ m(H) X 6.25 μ m(V) (PAL)	
Resolution	COLOR: 470 TV-LINE, B/W: 520 TV-LINE	
TV Type	NTSC/PAL	
Sync. Type	Internal	
Scanning System	2:1 Interlace	
Video Output	1.0 Vp-p (Sync. Negative)	
Gamma Characteristic	$\gamma = 0.45$ typ.	
Min. Illumination	0 Lux(20M Range) : LED ON 0.01Lux(F/1.2) : LED OFF	
S/N Ratio	45dB or More (AGC OFF)	
Shutter	1/60 ~ 1/100,000 sec(NTSC)	
AGC	ON /OFF	
BLC	ON /OFF	
FLICKERLESS	ON /OFF	
DAY&NIGHT Filter exchange	AUTO	
Digital Zoom	x1, x2, x3	
Audio gain (option)	40dB \pm 10%	
Max output (option)	600ohm Max 3Vpp \pm 10%	
Freq. Response (option)	300Hz~20KHz	
Audio S/N ratio (option)	-45dB \pm 10%	
Power Supply	Regulated DC 12.0 V	
Consumption Current	Max.500mA at DC 12V, Motor Drive (LED ON) Max.520mA at DC 12V, Motor Drive, AI LENS (LED ON)	
Reverse Polarity Protection	Yes	
Lens	Board Lens Vari-focal Auto Iris lens	
Operation Temp	-10 ~ 50° C	
Preservation Temp	-20 ~ 60° C	

•HIGH RESOLUTION COLOR CAMERA-HQ1

Model No	SK-D100IR/M410(AI)	SK-D100IR/M410X(AI)
Image Sensor	1/3" COLOR SUPER HAD CCD 1/3" COLOR EXview HAD CCD	
Effective pixel	762(H) X 492(V) PIXELS(NTSC), 752(H) X 582(V) PIXELS(PAL)	
Cell Size	6.35 μ m(H) X 7.40 μ m(V) PIXELS(NTSC), 6.50 μ m(H) X 6.25 μ m(V) PIXELS(PAL)	
Resolution	520TV-LINE	
TV Type	NTSC, PAL	
Sync. Type	Internal	
Scanning System	2:1 Interlace	
Video Output	1.0 Vp-p (Sync. Negative)	
Gamma Characteristic	0.45typ.	
Min. Illumination	0Lux(20M Range) : LED ON 0.5Lux(F/1.2) : LED OFF 0.01Lux(F/1.2) : LED OFF	
S/N Ratio	45dB or More(AGC OFF)	
Gain Control	Automatic	
Shutter	AUTO:1/60~1/100,000second(NTSC), 1/50~1/100,000second(PAL) Flickerless off: 1/60/50second, On: 1/1001/120second	
Test Illuminance Area	Average test illuminance by front view	
Audio gain (option)	40dB \pm 10%	
Max output (option)	600ohm Max 3Vpp \pm 10%	
Freq. Response (option)	300Hz~20KHz	
Audio S/N ratio (option)	-45dB \pm 10%	
Anti color rolling	Built-in(NTSC)	
White Balance	ATW	
BLC	ON/OFF(Selectable-option*)	
Mirror	OFF(ON-option*)	
Flickerless	OFF(ON-option*)	
AGC	Normal(High-option*)	
White spots compensation	Automatic	
Power Supply	Regulated DC 12.0 V	
Consumption Current	380mA Max.(LED ON)	
Reverse Polarity Protection	Yes	
Lens	Fixed focal board lens or Vari-focal auto Iris lens	
Operation Temp	-10 ~ 50° C	
Preservation Temp	-20 ~ 60° C	

*When we produce, we can make the setting of options as you request.

* All specification is subject to change without notice to improve the quality.

●SETUP FOR CAMERA FUNCTIONS

-(SK-D100IR/M400X(AI)only)

•Function setting combination

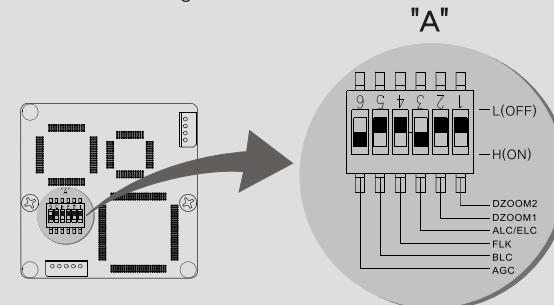

•Dip switch combination

	H(ON)	L(OFF)
AGC	AGC ON	AGC OFF
BLC	BLC ON	BLC OFF
FLK	Flickerless ON	Flickerless OFF
ALC/ELC	ALC	ELC

*ALC : Auto IRIS Lens(DC type)

*ELC : Board Lens

	x1	x2	x3
DZOOM1	L(H)	H	L
DZOOM2	L(H)	L	H