



S MA9321-EHTV

Multi-Sensor Adjustable Dome Network Camera



20MP Total Resolution • Multi-Directional • Adjustable Views • Remote Focus • SNV • WDR Pro • IP66 • IK10 • -40°C ~ 50°C

The new MA9321-EHTV is the most versatile product offering to date from VIVOTEK. The MA9321-EHTV provides high resolution images through four independent sensors, and remote focus lenses. By having each sensor independent of each other, the MA9321-EHTV can view four different regions simultaneously and therefore reduce the total number of cameras needed for surveillance, helping to lower total installation time and costs.

Featuring four independent 5MP CMOS Sensors, the MA9321-EHTV network camera can provide the most flexibility in surveillance monitoring. Each sensor utilizes a 3.7 to 7.7 mm remote focus lens and 3-axis design along a circular track to enable full 360° coverage. This enables the MA9321-EHTV to capture every angle for comprehensive video coverage from a single IP address, making this camera ideally suited for surveillance in areas such as hallway intersections, building corners, parking garages/lots, and shopping malls.

The MA9321-EHTV is equipped with a removable IR-cut filter and WDR Pro technology, enabling the camera to maintain optimal image quality and unparalleled visibility in high contrast lighting environments. Furthermore, the MA9321-EHTV employs VIVOTEK's Smart Stream III technology and H.265 compression codec, reducing bandwidth more than 90%* while still maintaining excellent image quality compared to traditional H.264 without smart streaming.

In addition to its versatile coverage, the MA9321-EHTV is armed with a robust IP66 and IK10-rated housing to enable the multi-directional camera to withstand rain and dust as well as to protect against vandalism or tampering.

Key Features

- 20-Megapixel Total Resolution
- 4 Independent Sensors, Adjustable Views
- 30 fps (2688x1920) per Sensor
- Remote Focus
- H.265 Compression Technology
- Removable IR-cut Filter for Day & Night Function
- Smart Stream III to Optimize Bandwidth Efficiency
- SNV (Supreme Night Visibility) for Low Light Conditions
- WDR Pro to Provide Extreme Visibility in Extremely Bright or Dark Environments
- Weather-proof IP66-rated and Vandal-proof IK10-rated Housing
- -40°C ~ 50°C Wide Temperature Range for Extreme Weather Conditions
- Built-in Microphone



Multiple sensors, Adjustable views

Technical Specifications

Model	MA9321-EHTV	Interface	Built-in microphone External microphone input External line output
System Information		Effective Range	5 meters
CPU	Multimedia SoC (System-on-Chip)	Network	
Flash	8GB	Users	Live viewing for up to 10 clients
RAM	4GB	Protocols	IPv4, IPv6, TCP/IP, HTTP, HTTPS, UPnP, RTSP/ RTP/RTCP, IGMP, SMTP, FTP, DHCP, NTP, DNS, DDNS, PPPoE, CoS, QoS, SNMP, 802.1X, ARP, SSL, TLS, CIFS/SMB
Camera Features		Interface	10 Base-T/100 Base-TX/1000 Base-T Ethernet (RJ-45) *It is highly recommended to use standard CAT5e & CAT6 cables which are compliant with the 3P/ETL standard.
Image Sensor	1/2.7" Progressive CMOS	ONVIF	Supported, specification available at www.onvif.org
Maximum Resolution	2688x1920 (5MP) x 4	Intelligent Video	
Lens Type	Vari-focal, Remote Focus	Video Motion Detection	Five-window video motion detection
Focal Length	f = 3.7 ~ 7.7 mm	VADP Package	Genetec package, Trend Micro IoT Security
Aperture	F1.9 ~ F2.9	Alarm and Event	
Iris Type	Fixed-iris	Alarm Triggers	Motion detection, manual trigger, digital input, periodical trigger, system boot, recording notification, camera tampering detection, audio detection, MicroSD card life expectancy
Field of View	40.0° ~ 84.4° (Horizontal) 28.6° ~ 59.8° (Vertical) 49.2° ~ 104.5° (Diagonal)	Alarm Events	Event notification using digital output, HTTP, SMTP, FTP, NAS server and MicroSD card File upload via HTTP, SMTP, FTP, NAS server and MicroSD card
Shutter Time	1/5 sec. to 1/32,000 sec.	General	
WDR Technology	WDR Pro	Connectors	RJ-45 cable connector for 10/100/1000Mbps Network/PoE connection Audio input Audio output AC 24V power input Digital input *1 Digital output *1
Day/Night	Yes	LED Indicator	System power and status indicator
Removable IR-cut Filter	Yes	Power Input	AC 24V IEEE 802.3at PoE Class 4
Minimum Illumination	0.095 Lux @ F1.9 (Color) 0.005 Lux @ F1.9 (B/W)	Power Consumption	Max. 24 W
Tilt Range	0° ~ 105° each lens	Dimensions	Ø 210 x 110.4 mm Ø 210 x 96.7 mm (without cover plate)
Rotation Range	±90° each lens	Weight	1,572 g
Pan/Tilt/Zoom Functionalities	ePTZ: 48x digital zoom (4x on IE plug-in, 12x built-in)	Casing	IP66, IK10
On-board Storage	Slot type: MicroSD/SDHC/SDXC card slot Seamless Recording	Safety Certifications	CE, LVD, FCC Class A, VCCI, C-Tick, UL
Video		Operating Temperature	Starting Temperature: -30°C ~ 50°C (-22°F ~ 122°F) Working Temperature: -40°C ~ 50°C (-40°F ~ 122°F)
Compression	H.265, H.264, MJPEG	Humidity	90%
Maximum Frame Rate	30 fps @ (2688x1920) x 4	Warranty	36 months
Maximum Streams	3 simultaneous streams	System Requirements	
S/N Ratio	67 dB		
Dynamic Range	120 dB		
Video Streaming	Adjustable resolution, quality and bitrate, configurable video cropping for bandwidth saving, Smart Stream III		
Image Settings	Time stamp, text overlay, flip & mirror, scheduled profile settings, configurable brightness/contrast/saturation/sharpness, white balance, exposure control, gain, backlight compensation, privacy masks, 3DNR		
Audio			
Audio Capability	Two-way Audio (full duplex)		
Compression	G.711, G.726		

Technical Specifications

Operating System	Microsoft Windows 7/8
Web Browser	Internet Explorer 10/11
Other Players	VLC: 1.1.11 or above QuickTime: 7 or above

Included Accessories

Others	Quick installation guide, warranty card, alignment sticker, desiccant bag, screw driver, screws pack
--------	--

Dimensions

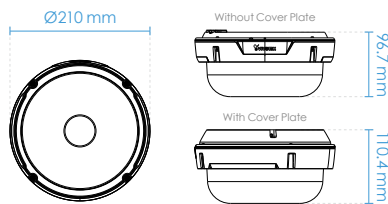

Compatible Accessories

Mounting Kits



AM-529
Mounting Adapter
(1.5" PS11 Male
Connector)



AM-116/117
Pendant Pipe
(1.5" PS11)
(20 cm/40cm)



AM-114
Pendant Head
(Outdoor)



AM-21C
Wall Mount Bracket



AM-314
Pole Mount Adapter



AM-414
Corner Mount Adapter